

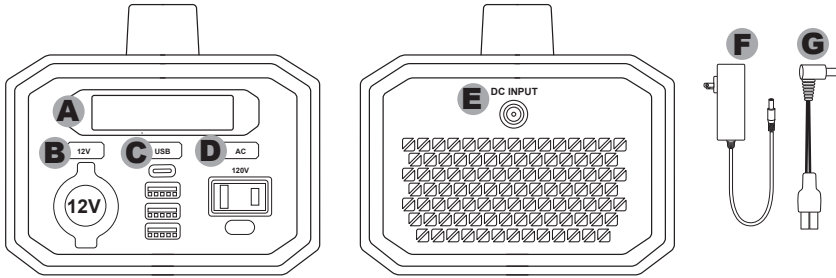

## Product Details



- A. LCD Screen: See details at right
- B. 12V Power Button and Accessory Socket
- C. USB Power Button and Ports
- D. AC Power Button and Outlet
- E. DC Input Port: Use AC charger, solar panel or 12V DC source
- F. AC Charger
- G. Solar Input Cable with Anderson connectors

## LCD Screen Details

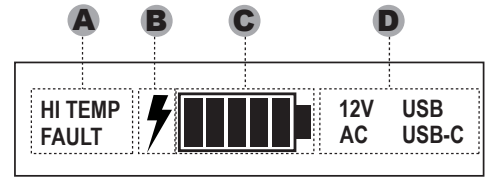

- A. Warning Indicators
  - HI TEMP
  - FAULT
- B. Charging Indicator
- C. Fuel Gauge
- D. Active Output Ports
  - 12V
  - AC
  - USB
  - USB-C

## Getting Started: Charging your Battery Generator

- IMPORTANT - CHARGE BEFORE USE:** Fully charge the Battery Generator before using it and/or storing it. Keep the unit plugged in when not in use so it is ready when you need it. The charger is designed to maintain the battery in a healthy state.
- BEFORE YOU START:** See "Safety Information" section for important precautions. The user should conform to all safety precautions in the guide. Keep this guide in a safe place for future reference.
- IMPORTANT:** The Battery Generator should be placed in a dry, well ventilated area with at least 6 inches of space on all sides for proper ventilation.
- IMPORTANT:** The 12V, AC and USB ports must be turned Off after use in order to conserve battery energy.

- The Battery Generator can be charged from grid power (AC or Type-C USB) or solar energy (solar panels).
- If your Battery Generator is fully discharged (0% available power), the LCD screen will be completely dark. This screen will illuminate as soon as the Battery Generator is connected to power, letting you know that the unit is charging, and will continually display the charge level as the Battery Generator charges.

## Charging your Battery Generator from an AC outlet

### Estimated Charge Time: 7 hours to full

NOTE: The 7 hour charge time may vary depending on your AC outlet power and the climate (Battery Generator may charge more slowly in very high or low temperatures).

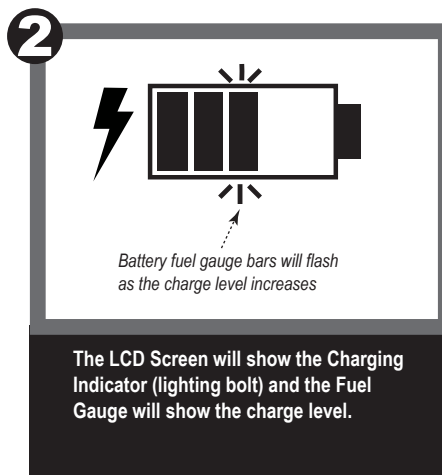
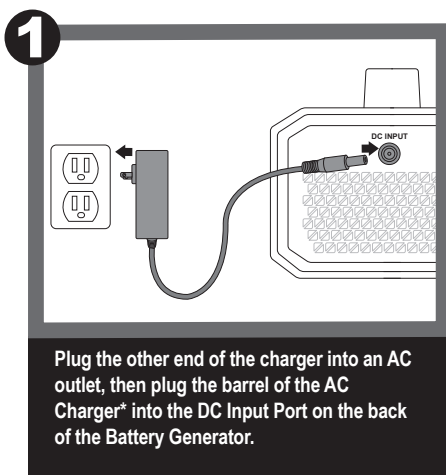

### Keep charged for immediate use

You may keep the Battery Generator plugged into your AC outlet for maintenance charging. The internal charger is designed to optimize power without overcharging the battery. We recommend keeping your Battery Generator charged so it provides maximum power when you need it.

\*AC charger is included with the Battery Generator

### Important Note:

All outputs (AC, 12V DC, and USB) will automatically turn off during charging via AC, solar or Type-C USB input.

# Getting Started (cont'd)

## Charging your Battery Generator from a solar panel

 **Estimated Charge Time: 5 hours to full**

NOTE: The DC Input port will automatically optimize the voltage and current to provide the most efficient charging to the Battery Generator.

NOTE: The five hour charge time may vary depending on solar exposure and the climate (Battery Generator may charge more slowly in very high or low temperatures).

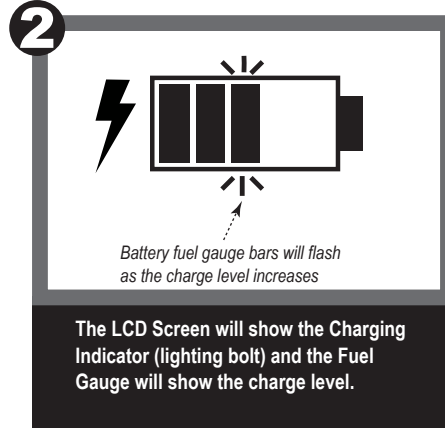
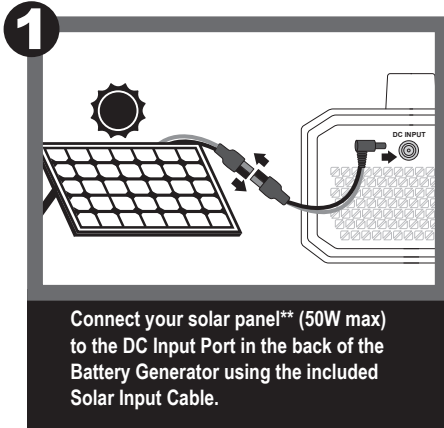

### Optimizing Your Solar Charging

The DC Input port can take up to 50W of charging power.

To obtain the fastest charge time, position your solar panel where it will receive the maximum exposure to direct sunlight. If the solar panel is placed in shade or is used in cloudy conditions, it may take significantly longer to charge your Battery Generator.

You may also keep the Battery Generator connected to the solar panel for continued charging. It is recommended to keep the Battery Generator charged so it is ready any time.

\*\*Solar panel sold separately

## Charging your Battery Generator from a Type-C USB charger

 **Estimated Charge Time: 4 hours to full**

NOTE: The Type-C USB wall charger is sold separately and is not included with the Battery Generator.

NOTE: You may also charge the Battery Generator with a Type-C car charger. To use a car charger, follow Step 1 below, except plug your Type-C charger into your car's 12 Volt DC power outlet.

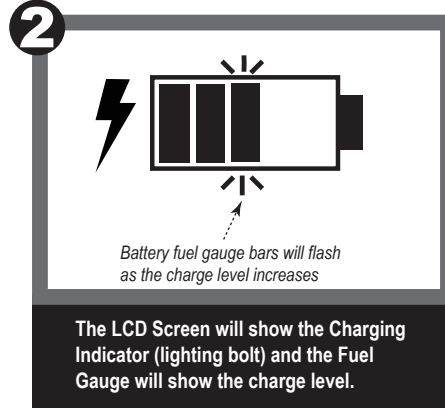
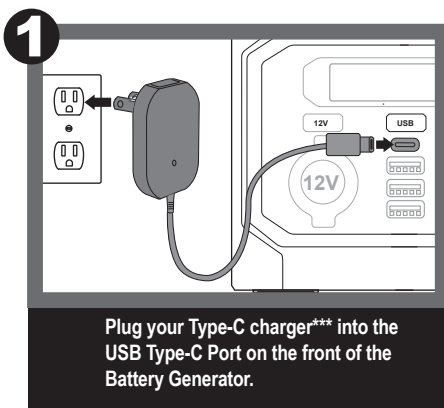

### Using the Type-C Port to charge your Battery Generator

Input is 60W. To optimize charge time when using the Type-C port, use at least a 60W charger. Lower power Type-C chargers will result in longer charge times

\*\*\*Type-C charger sold separately

## Using your Battery Generator

 Each output port (12V, USB, AC) has a separate power button. The active port(s)' name(s) are indicated in the LCD display. Once all the ports are off, the LCD display turns off after 4 seconds.

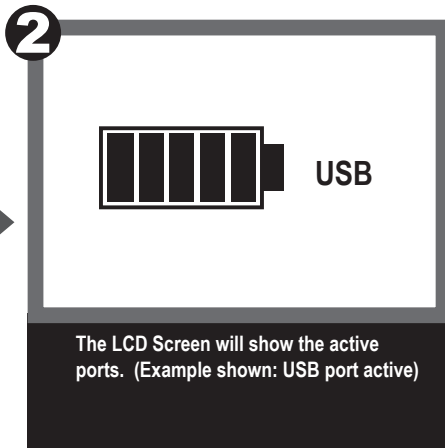
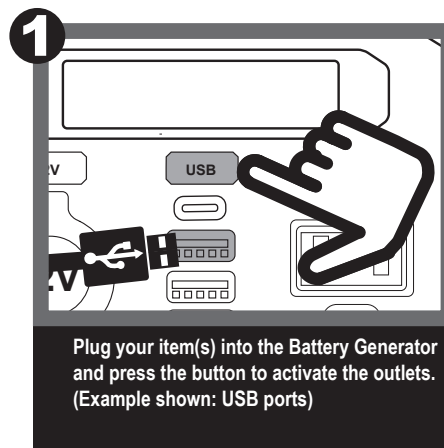

### Connecting Multiple Items

NOTE: The 12V accessory socket and AC outlet can NOT be used simultaneously due to power limitations. The USB ports can be used simultaneously with other ports.

### Conserving Battery Power

When you are done using the outlet(s) and USB port(s), press the button again to turn them off. This will keep the internal battery from passively draining.

# Reference

## Household Items: Typical Estimated Run Times With Battery Generator

Device	Continuous draw (Watts)	Run Time
LED String lights (3.3 W)	3.3W	67 hours
LED Light Bulb (100 W Equivalent)	14W	15 hours
LED Light Bulb (60 W Equivalent)	8.2W	27 hours
Incandescent light bulb (60W)	58.8W	4 hours
CPAP (65 W) RESMED AIR10	53W	4 hours
TV (42" LED) (100 W) + DVR	48W	5 hours
Cable modem + Wi-Fi router (12.5W)	13W	18 hours
Laptop	51Wh Battery	3 charges
Smartphone	11Wh Battery	14 charges

### Important Note:

These items' power draw and run times are examples only and actual results may vary. Consult the manual of your specific device for details on its actual power consumption.

### Not Recommended For:

Air conditioners or items with heating elements such as space heaters, rice cookers and hot plates.

Additional high-surge devices such as circular saws, blenders and sump pumps are also not recommended for use with the Battery Generator.

## Troubleshooting Guide

Your Battery Generator features several built-in protection features to ensure safe and efficient operation. Below is a guide which shows the typical faults that occur during normal operation and how to correct them and resume use.

If a fault occurs, the following warning(s) will appear on the LCD screen. Please refer to the table below to safely correct any problems and allow your Battery Generator to reset and resume operation. If you have additional questions, please contact Customer Service at (1-888-617-5884).

Fault Type	What it means	What to do
HI TEMP	Your Battery Generator is too hot (operating temperature range is -10° to 45° C / 14° to 113° F)	Allow the Battery Generator to cool down or move to a cooler location
FAULT	Overload, under voltage, over voltage or short circuit detected	Check for excessive load, low battery level or short circuit in the connected device.

## Safety Information

This section contains important safety information. Before using the product, READ ALL instructions and cautionary markings on or provided with the product, and all appropriate sections of this guide. The product contains no user-serviceable parts. SAVE THESE INSTRUCTIONS.

### ⚠ IMPORTANT SAFETY INSTRUCTIONS - SAVE THESE INSTRUCTIONS

- ⚠ WARNING – When using this product, basic precautions should always be followed, including the following:**
- Read all the instructions before using the product.
  - To reduce the risk of injury, close supervision is necessary when the product is used near children.
  - Do not put fingers or hands into the product.
  - Do not expose Battery Generator to rain or snow.
  - Use of an attachment not recommended or sold by Battery Generator manufacturer may result in a risk of fire, electric shock, or injury to persons.
  - To reduce risk of damage to the electric plug and cord, pull the plug rather than the cord when disconnecting the Battery Generator.
  - Do not use the Battery Generator or appliance that is damaged or modified. A damaged or modified Battery Generator may exhibit unpredictable behavior resulting in fire, explosion or risk of injury.
  - Do not operate the Battery Generator with a damaged cord or plug, or a damaged output cable.
  - Do not disassemble the Battery Generator, take it to a qualified service person when service or repair is required. Incorrect reassembly may result in a risk of fire or electric shock.
  - To reduce the risk of electric shock, unplug the Battery Generator from the outlet before attempting any instructed servicing.

#### PERSONAL PRECAUTIONS

- When charging the internal battery, work in a well ventilated area and do not restrict ventilation in any way.
- Do not expose a Battery Generator to fire or excessive temperature. Exposure to fire or temperature above 130°C / 266°F may cause explosion.

#### ⚠ WARNING: NO USER SERVICEABLE PARTS

- There are no user serviceable parts in this unit, DO NOT attempt to open the Battery Generator; this is dangerous and will void the warranty.

#### ⚠ WARNING: HEAT GENERATION DURING CHARGING AND USE

- Charging and discharging generates heat and requires proper air flow. Use in a ventilated area and ensure adequate clearance for the ventilation grills. Blocking the grills may cause overheating and damage to the unit.

#### ⚠ WARNING: RISK OF ELECTRIC SHOCK INJURY

- Do not operate or store in moist conditions to avoid electric shock.
- If the unit gets wet wait for it to dry completely before using it.
- Do not insert foreign objects into any of the ports or openings.

#### ⚠ WARNING: RISK OF ELECTRIC SHOCK OR FIRE HAZARD

- Review the specifications of the Battery Generator ports and all connected devices you intend to use.
- The output ports can generate dangerous voltages.
- Do not use the Battery Generator if it is damaged or any of the input or output cords are damaged.

## Product Specifications

<b>Battery</b>	
Chemistry	Li-Ion
Capacity	11.07V 213Wh
<b>Input</b>	
DC Input	5–25V DC, 2.1A, 50W
USB - C PD (1x)	5V–3A/9V–3A/12V–3A/15V–3A/20V–3A, 60W Max
<b>AC Outlet</b>	
Number of outlets	1
AC Output	120V AC, 60Hz, Pure Sine Wave
AC Output (continuous)	200W
<b>DC 12V Port (1x)</b>	9–12.6V–10A Max
<b>USB Ports</b>	
USB - C PD (1x)	5V–3A/9V–3A/12V–3A/15V–3A/20V–3A, 60W Max
USB - A (3x)	5V, 2.4A per port (total 6.0A)

#### Operating Temperatures

Charging	0° – 45° C / 32° – 113° F
Discharging	-10° – 45° C / 14° – 113° F

#### Certifications

Safety	ANSI/CAN/UL2743
Efficiency	CEC/NRcan/DOE
EMI	FCC Part 15

#### Dimensions and Weight

Dimensions (LxWxH)	23.7 x 14.2 x 14.8 cm / 9.3 x 5.6 x 5.8 in
Weight	2.6 kg / 5.7 lb

# Support and Warranty

## Maintenance

In order to keep your Battery Generator operating efficiently, periodically clean and maintain your unit using the simple steps below.

- Clean the surface of the Battery Generator when necessary. Always use a soft sponge or cloth for cleaning. A mild, non-abrasive cleaning detergent may be used to remove stubborn dirt.
- Avoid using your Battery Generator in dirty conditions where foreign matter such as dust, dirt and moisture can clog the AC and USB outlets and charging ports. Keep the Battery Generator in a well-ventilated area away from direct exposure to outside elements whenever possible.
- Do not attempt to insert anything into the Battery Generator's openings to clean them, as this may result in injury or damage to the Battery Generator and void the warranty.
- Do not attempt to repair the Battery Generator yourself, as this may result in injury or damage to the Battery Generator and void the warranty. Please contact our Customer Service at 1-888-617-5884.

## FCC / ISED Information

This device complies with part 15 of FCC Rules. Operation is subject to the following two conditions: (1) This device may not cause harmful interference, and (2) this device must accept any interference received, including interference that may cause undesired operation.

Changes or modifications not expressly approved by the party responsible for compliance could void the user's authority to operate the equipment.

**NOTE:** This equipment has been tested and found to comply with the limits for a Class B digital device, pursuant to part 15 of the FCC Rules. These limits are designed to provide reasonable protection against harmful interference in a residential installation. This equipment generates, uses and can radiate radio frequency energy and, if not installed and used in accordance with the instructions, may cause harmful interference to radio communications. However, there is no guarantee that interference will not occur in a particular installation. If this equipment does cause harmful interference to radio or television reception, which can be determined by turning the equipment off and on, the user is encouraged to try to correct the interference by one or more of the following measures:

- Reorient or relocate the receiving antenna.
- Increase the separation between the equipment and the receiver.
- Connect the equipment into an outlet on a circuit different from that to which the receiver is connected.
- Consult the dealer or an experienced radio/TV technician for help.

CAN ICES-003 (B) / NMB-003 (B)

## Contacting Customer Support

If you experience any problems or have any questions regarding your product, free technical support is available. Call from a phone where you have access to your product.

Be prepared to provide the following information:

- Name, address and telephone number
- Name of the product
- Make and model of any items or devices that you are using with the product
- Symptoms of the problem(s) and what led to them

Technical Support is available by telephone: 1-888-617-5884  
or by email at [Info@Battery-Biz.com](mailto:Info@Battery-Biz.com)

Written inquires should be directed to:  
Battery-Biz Inc.;  
Coleman Product Inquiry  
1380 Flynn Road, Camarillo, CA 93012, USA

## Recycling Information

Battery-Biz is committed to environmental responsibility and recommends that electronic devices be disposed of properly. Please contact your local city offices for information on recycling and disposal programs for e-waste.

For instructions on how to recycle this product visit <http://www.call2recycle.org>.

## Two Year Limited Warranty

This product (Product) is warranted (Limited Warranty) by Battery-Biz Inc. (Distributor) against defects in material and workmanship under normal use and service to the original purchaser (Purchaser) for a period of 2 (two) years (Warranty Period) from the original date of purchase. The Limited Warranty does not extend to any subsequent owner or other transferee of the Product. Purchaser shall retain the dated sales receipt as evidence of proof and date of purchase as it will be required for any warranty claim or service. In order to keep the Limited Warranty in effect, the Product must have been handled and used as described in the instructions accompanying this Limited Warranty. The Limited Warranty does not cover any damage due to accident, improper storage, improper installation, modifications, unauthorized repair, normal wear and tear, failure to observe product specifications or safety warnings, force majeure, misuse, abuse or negligence. This Limited Warranty shall be null and void if Product's label(s) have been defaced, altered, or removed.

### Remedies Under Warranty

With respect to a defective Product during the Warranty Period, Distributor in its sole and absolute discretion, will either: (a) repair or replace such Product (or the defective part) free of charge or (b) refund the purchase price of such Product. Distributor will pay for shipping and handling fees to return the repaired or replacement product to the Purchaser during the Warranty Period.

### Disclaimer Of Warranty

The Limited Warranty described herein is Purchaser's sole remedy. To the extent permitted by law, Distributor disclaims all other implied or express warranties on Product including all warranties of merchantability and/or fitness for any particular purpose.

### Limitation Of Liability

Except to the extent of repairing or replacing Product as expressly stated in the Limited Warranty described herein, Distributor shall not be liable for any damages, whether direct, indirect, incidental, special, consequential, exemplary, or otherwise, including lost revenues, lost profits, loss of use of software, loss or recovery of data, rental of replacement equipment, downtime, damage to property, and third-party claims, arising out of any theory of recovery, including statutory, contract or tort. Notwithstanding the terms of any limited or implied warranty or in the event that the Limited Warranty fails in its essential purpose, in no event will Distributor's entire liability exceed the purchase price of the Product. Some states and provinces do not allow the exclusion or limitation of incidental or consequential damages so the above limitations or exclusions and as a result may not apply to Purchaser. This Limited Warranty gives Purchaser specific legal rights. Purchaser may have other rights which vary from state to state and province to province.

In order to be considered for coverage under this Limited Warranty, all warranty returns of Product to Distributor must include (1) a copy of the original receipt for the purchase of Product, (2) a letter from Purchaser referencing the Return Merchandise Authorization number issued by Distributor to Purchaser with a description of the problem, and (3) Purchaser's contact information including phone number and shipping address. Purchaser is responsible for the cost of the warranty return shipping and handling as well as any related claims that may arise.

## Product Registration

For complete warranty coverage, please register your Coleman product within fourteen days of purchase.

**Visit [ColemanPowerStations.com/Register](http://ColemanPowerStations.com/Register)**

or scan the QR code to register.

