

WHAT'S INSIDE:

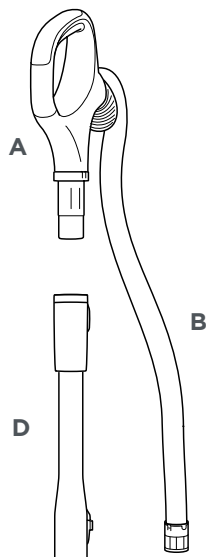

- A** Handle
- B** Hose
- C** Vacuum Pod
- D** Wand
- E** Motorized Floor Nozzle
- F** Duster Crevice Tool
- G** Pet Multi-Tool
- H** Pet Power Brush
- I** Multi-Angle Dusting Brush

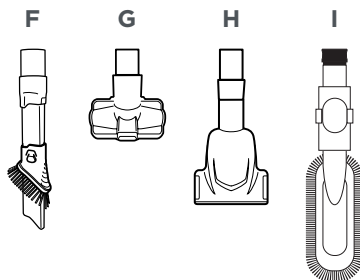
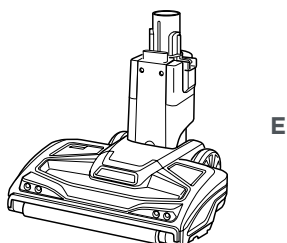
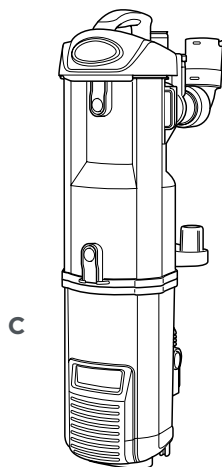

For additional parts and accessories, visit sharkaccessories.com

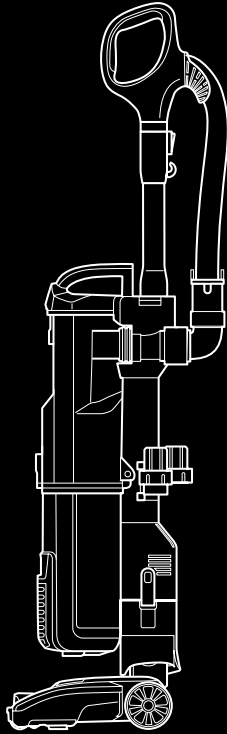

Shark[®]

**For questions or to register your product, contact us at
1-800-798-7398 or visit us online at sharkclean.com**



@sharkcleaning

©2017 SharkNinja Operating LLC. SHARK is a registered trademark of SharkNinja Operating LLC.
DUOCLEAN and JOIN THE CLEAN EVOLUTION are trademarks of SharkNinja Operating LLC.

NV202_QSG_PLT_170324

Please be sure to read the enclosed Shark® Owner's Guide prior to using your unit.

Shark®

SLIM

THE ONLY
duoclean™
DUAL BRUSHROLL

QUICK START GUIDE

Use this Quick Start Guide
to learn about your new
vacuum's great features.



NV202

ASSEMBLY

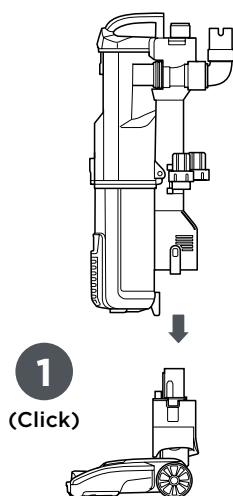

Place pod onto motorized floor nozzle.

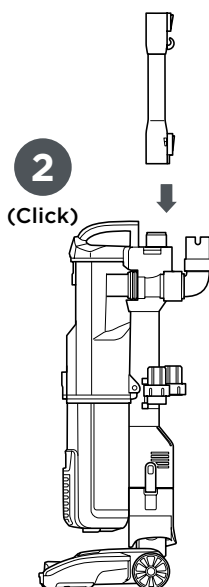

Insert wand into top of pod.

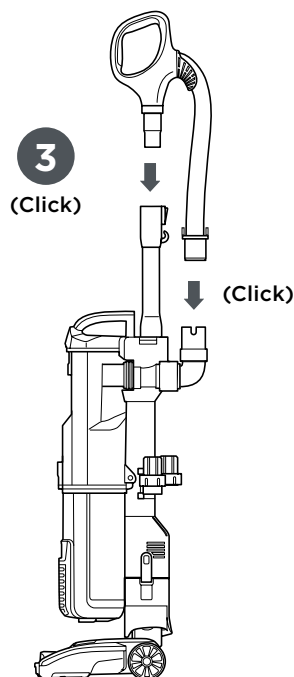

Insert handle into top of wand, then connect hose to back of pod, pressing until it clicks into place.

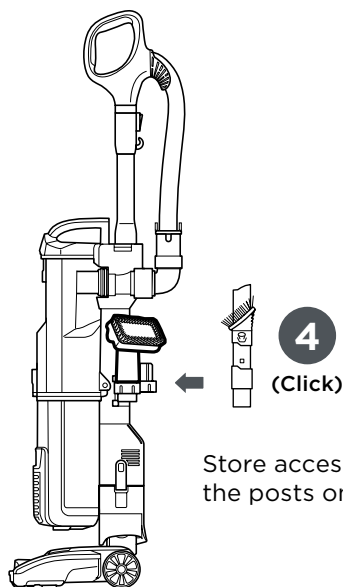

Store accessories on the posts on the pod.

Join The Clean Evolution.™

**When it comes to
cleaning, we're not afraid
to get our hands dirty.**

**At Shark®, we're constantly
working to evolve and
innovate products to meet
the needs of people like
you. Because our job is
to make 5-star-worthy
products that make your
life a whole lot easier.**

HAVING TROUBLE?

ISSUE

Vacuum is not picking up debris. No suction or light suction.

Solution

Empty dust cup, clean filters, check all openings for blockages.

ISSUE

Vacuum lifts area rugs.

Solution

Turn off the unit to disengage the brushroll, then restart by pushing the Power button.

ISSUE

Brushroll and/or Soft Roller does not spin. The Brushroll Indicator Light on the floor nozzle turns red.

Solution

Turn off and unplug the vacuum immediately. Remove any blockages, then reconnect and turn vacuum back on. If Brushroll Indicator Light on the floor nozzle is green, the blockage has been successfully cleared. If the light is still red, please contact customer service at 1-800-798-7398.

1

UPRIGHT

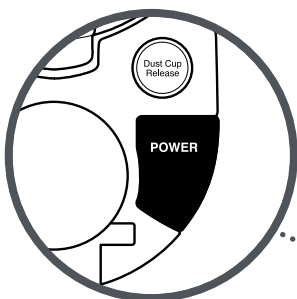
**Power**

Push the POWER button to turn the vacuum on or off.

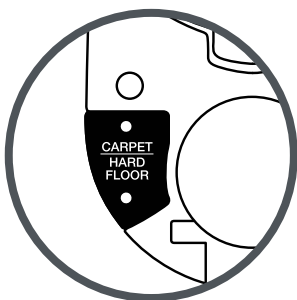
**Brushroll Operation**

In Carpet mode, brushroll spins fast (green light)

In Hard Floor mode, brushroll spins slowly (no light)

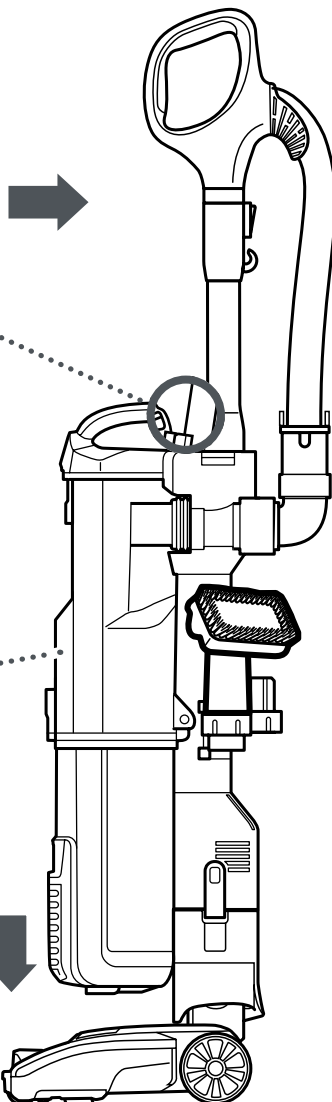

2

ABOVE THE FLOOR

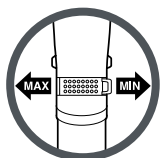

**Suction
Control**

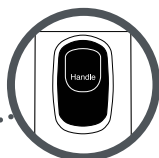

**Handle
Release**



**Wand
Release**

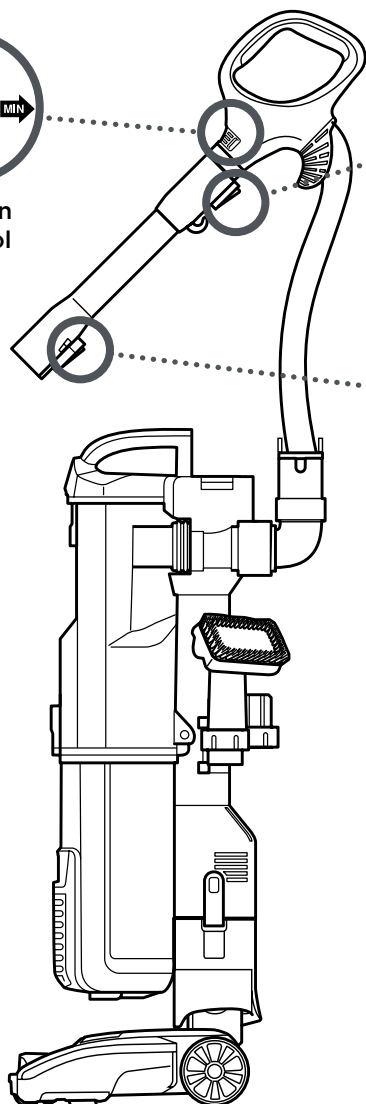

Attach any of the
specialized cleaning
accessories to the
handle or wand.

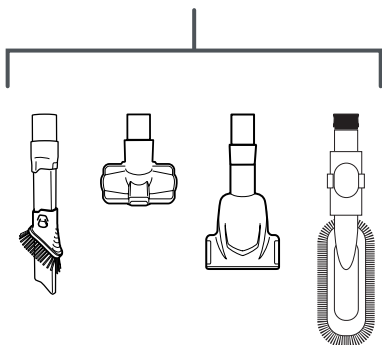

DUOCLEAN™ TECHNOLOGY

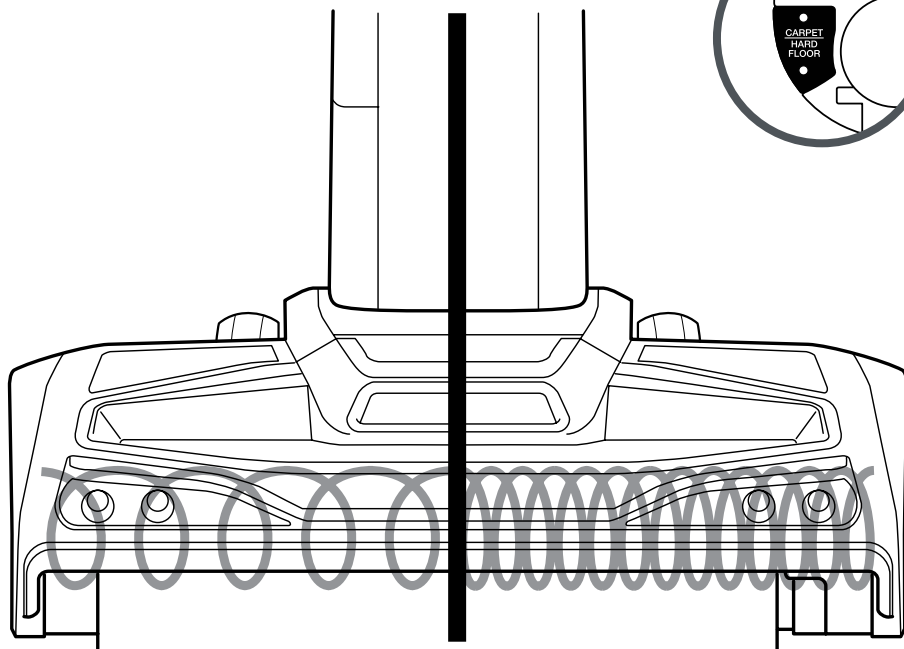
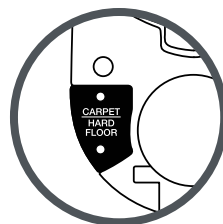

ON FLOORS

Direct engagement with the Soft Roller removes large particles, small particles, and stuck-on dust.

Hard Floor

Gentle on bare floors and delicate area rugs.

ON CARPETS*

The Soft Roller pulls in large particles, while the deep-cleaning bristle brush removes embedded fine dirt.

Carpet

Optimized brushroll speed for carpets.

* For deep cleaning per ASTM F 608 (embedded dirt in carpet) please use in Carpet mode with suction control closed.

MAINTENANCE

Empty dust cup after each use

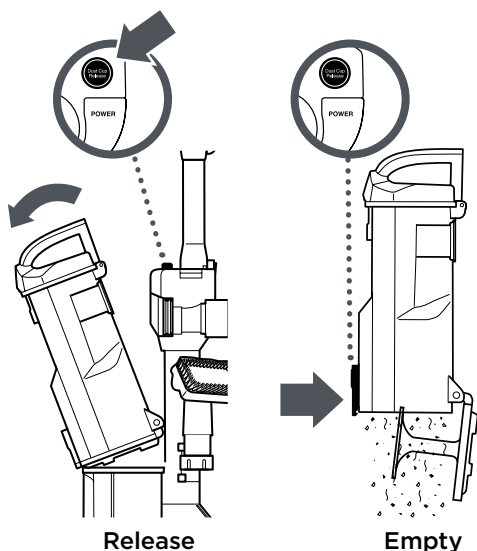

TIP:

Wash filters once every month to keep the suction strong.

Rinse filters and allow to air-dry completely. Tap loose dirt from foam filters as needed between washes.

Maintaining the Soft Roller

Lift out the brushroll to easily remove any string, hair, or debris that may be wrapped around it. Slide the Soft Roller access button up to remove the Soft Roller for cleaning.

